

FORM NO 1.

Courses & distances up Creek

West 32.
 S. 61 3/4 W. 8.6
 S. 24 1/2 W. 9.7
 S. 3. E 15.
 S. 17. W. 9.5

 74.8

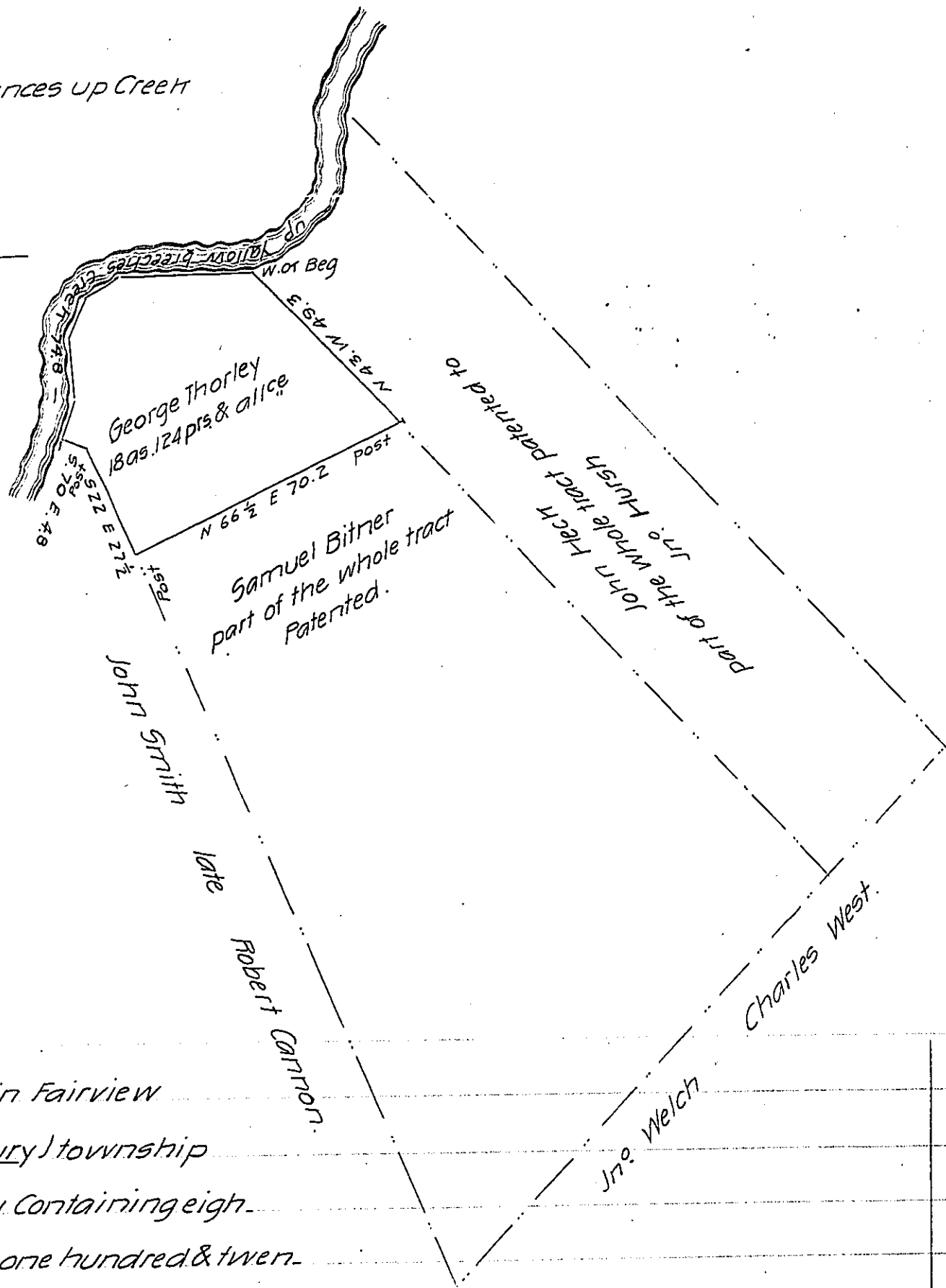

Situate in Fairview

(late Newbury) township

York County containing eight

teen acres, one hundred & twen-

ty four perches and allowance of six pr. Cent. Part of a larger tract of

152 as. & allowance. Surveyed by Charles Lukens then D.S. on the

day of July 1771, in pursuance of a Warrant granted to George Thorley

for 200 as. dated 10th January 1771. Resurveyed & divided 9th Decem-

ber 1830 for John Heck

Isaac Kirk D.S.

To Jacob Spangler Esquire

Surveyor General.

IN TESTIMONY that the above is a copy of the original remaining on file in the Department of Internal Affairs of Pennsylvania, made conformably to an Act of Assembly approved the 16th day of February, 1833, I have hereunto set my Hand and caused the Seal of said Department to be affixed at Harrisburg, this twenty-first day of March 1907

Isaac R. Brown
 Secretary of Internal Affairs.